



City of Boston
Parks and Recreation

FRIENDS OF THE
PUBLIC GARDEN
69 BEACON STREET
BOSTON, MA 02108

IN CONJUNCTION
WITH THE BOSTON
PARKS & RECREATION
DEPARTMENT

HALVORSON
Tight & Bond STUDIO

55 KINDESTON ST. BOSTON MA 02111-2200
PHONE: 617-554-0390
WWW.HALVORSONDESIGN.COM

RESTORATION OF CHILD FOUNTAINS TO
AND LANDSCAPE IMPROVEMENTS TO
THE ARLINGTON ST. ENTRANCE OF
THE PUBLIC GARDEN
BOSTON, MA

REVISIONS

PROJECT NO: 155026001

DRAWN BY:

CHECKED BY:

SCALE: 1/16" = 1'-0"

CONSTRUCTION
DOCUMENTS

MAY 2023

EXISTING
CONDITIONS PLAN

L0.0

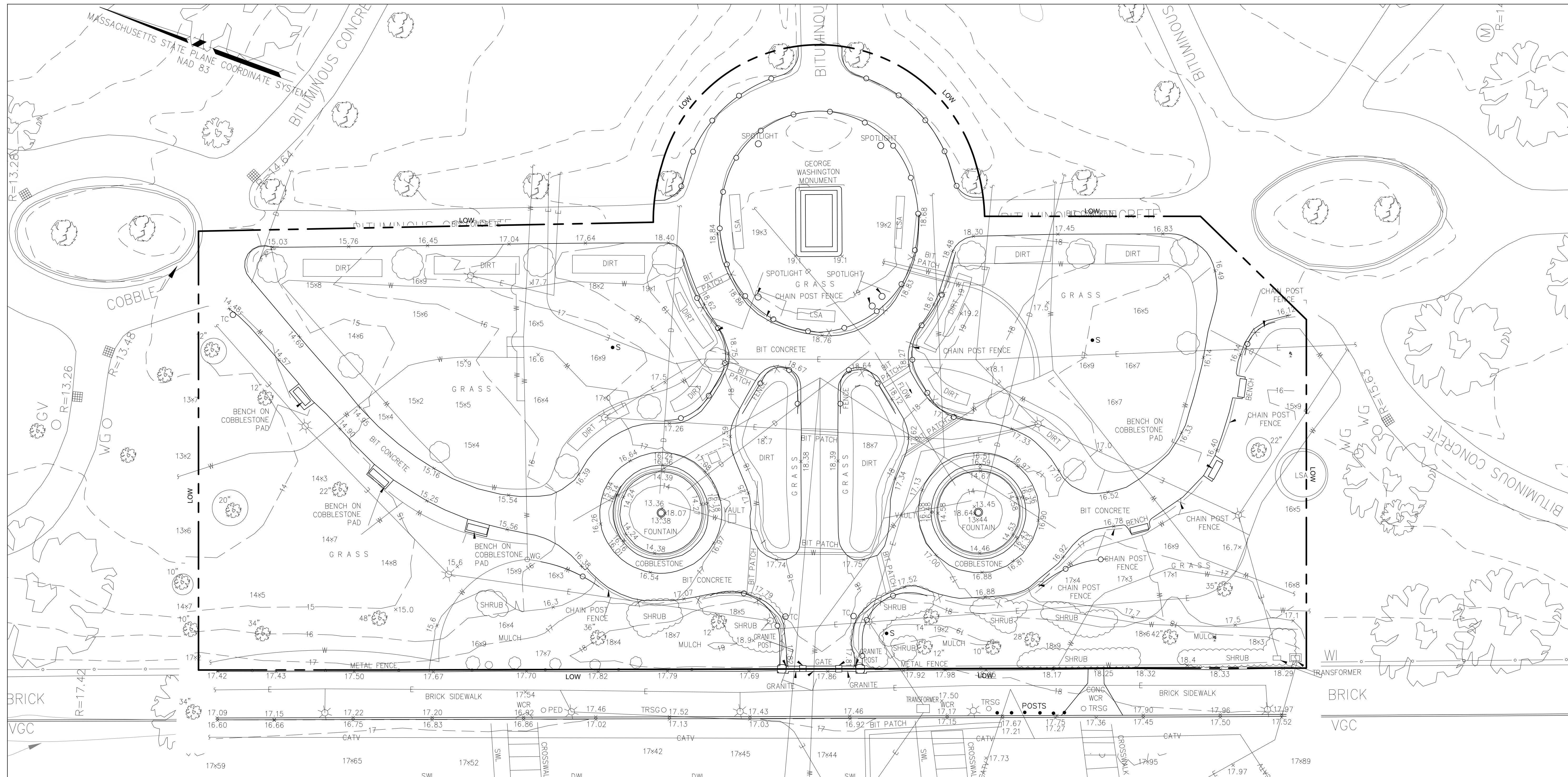

EXISTING CONDITIONS NOTES:

1. EXISTING CONDITIONS SURVEY (DATED: JULY 5TH, 2019) WAS PROVIDED BY NITSCH ENGINEERING, 2 CENTER PLAZA SUITE 240, BOSTON, MA 02108

UTILITY INFORMATION STATEMENT

- 1. THE SUB-SURFACE UTILITY INFORMATION SHOWN HEREON IS COMPILED BASED ON FIELD SURVEY INFORMATION, RECORD INFORMATION AS SUPPLIED BY THE APPROPRIATE UTILITY COMPANIES, AND PLAN INFORMATION SUPPLIED BY THE CLIENT, IF ANY; THEREFORE WE CANNOT GUARANTEE THE ACCURACY OF SAID COMPILED SUB-SURFACE INFORMATION TO ANY CERTAIN DEGREE OF STATED TOLERANCE. ONLY PHYSICALLY LOCATED SUB-SURFACE UTILITY FEATURES FALL WITHIN NORMAL STANDARD OF CARE ACCURACIES.
- 2. THE LOCATIONS OF UNDERGROUND PIPES, CONDUITS, AND STRUCTURES HAVE BEEN DETERMINED FROM SAID INFORMATION, AND ARE APPROXIMATE ONLY. COMPILED LOCATIONS OF ANY UNDERGROUND STRUCTURES, NOT VISIBLY OBSERVED AND LOCATED, CAN VARY FROM THEIR ACTUAL LOCATIONS.
- 3. ADDITIONAL BURIED UTILITIES/STRUCTURES MAY BE ENCOUNTERED.
- 4. THE STATUS OF UTILITIES, WHETHER ACTIVE, ABANDONED, OR REMOVED, IS AN UNKNOWN CONDITION AS FAR AS OUR COMPILATION OF THIS INFORMATION.
- 5. IT IS INCUMBENT UPON INDIVIDUALS USING THIS INFORMATION TO UNDERSTAND THAT COMPILING UTILITY INFORMATION IS NOT EXACT, AND IS SUBJECT TO CHANGE BASED UPON VARYING PLAN INFORMATION RECEIVED AND ACTUAL LOCATIONS.
- 6. THE ACCURACY OF MEASURED UTILITY INVERTS AND PIPE SIZES IS SUBJECT TO FIELD CONDITIONS, THE ABILITY TO MAKE VISUAL OBSERVATIONS, DIRECT ACCESS TO THE VARIOUS ELEMENTS AND OTHER MATTERS.
- 7. THE PROPER UTILITY ENGINEERING/COMPANY SHOULD BE CONSULTED AND THE ACTUAL LOCATIONS OF SUBSURFACE STRUCTURES SHOULD BE VERIFIED IN THE FIELD (V.I.F.) BEFORE PLANNING FUTURE CONNECTIONS. CONTACT THE DIG SAFE CALL CENTER AT 1-888-344-7233, SEVENTY-TWO HOURS PRIOR TO EXCAVATION, BLASTING, GRADING, AND/OR PAVING.
- 8. AS OF THE DATE OF THIS PLAN RECORD INFORMATION HAS NOT BEEN RECEIVED BY NITSCH ENGINEERING FOR THE FOLLOWING UTILITIES:
 - VERIZON
 - BOSTON TRAFFIC LIGHTING
 - BOSTON FIRE DEPARTMENT

NOTES

- 1. THIS DOCUMENT IS AN INSTRUMENT OF SERVICE OF NITSCH ENGINEERING. IT IS ISSUED TO HALVORSON DESIGN PARTNERSHIP FOR PURPOSES RELATED DIRECTLY AND SOLELY TO NITSCH ENGINEERING'S SCOPE OF SERVICES UNDER CONTRACT WITH HALVORSON DESIGN PARTNERSHIP FOR THE BOSTON PUBLIC GARDEN. ANY USE OR REUSE OF THIS DOCUMENT FOR ANY REASON BY ANY PARTY FOR PURPOSES UNRELATED DIRECTLY AND SOLELY TO SAID CONTRACT AND PROJECT SHALL BE AT THE USER'S SOLE AND EXCLUSIVE RISK AND LIABILITY, INCLUDING LIABILITY FOR VIOLATION OF COPYRIGHT LAWS, UNLESS WRITTEN AUTHORIZATION IS GIVEN THEREFOR BY NITSCH ENGINEERING.
- 2. THE PURPOSE OF THIS PLAN IS TO SHOW A TOPOGRAPHIC SURVEY AS THE RESULT OF AN ON-THE-GROUND INSTRUMENT SURVEY WHICH OCCURRED ON 06-22-2019.
- 3. HORIZONTAL COORDINATES REFER TO MASSACHUSETTS STATE PLANE (NAD 83) BASED ON GPS RTK OBSERVATIONS.
- 4. ELEVATION REFERS TO BOSTON CITY BASE (BCB) VERTICAL BASED ON THE EXHIBIT 18-4 MASSHIGHWAY DATUM RELATIONSHIP CONVERSION TABLE.
- 5. THE INFORMATION CONTAINED ON THE DISK OR ELECTRONIC DRAWING FILE ACCOMPANYING THIS PLAN MUST BE COMPARED TO THE SEALED AND SIGNED HARD COPY OF THE PLAN TO ENSURE THE ACCURACY OF ALL INFORMATION AND TO ENSURE NO CHANGES, ALTERATIONS, OR MODIFICATIONS HAVE BEEN MADE. RELIANCE SHALL NOT BE MADE ON A DOCUMENT TRANSMITTED BY COMPUTER OR OTHER ELECTRONIC MEANS UNLESS FIRST COMPARED TO THE ORIGINAL SEALED DOCUMENT ISSUED AT THE TIME OF THE SURVEY. DUE TO THE CRITICAL NATURE OF SURVEYING, DATA ACQUISITION, AND AUTOCAD PLAN DEVELOPMENT, IF CRITICAL DIMENSIONAL INFORMATION IS NEEDED AND IS NOT SPECIFICALLY SHOWN ON THE ELECTRONIC DRAWING FILE, PLEASE CONTACT NITSCH ENGINEERING.

LEGEND

- CATCH BASIN
- CABLE TELEVISION MANHOLE
- MISCELLANEOUS MANHOLE
- SEWER MANHOLE
- TELEPHONE MANHOLE
- WATER GATE
- IRRIGATION CONTROL VALVE
- BOSTON WATER WORKS
- FIRE HYDRANT
- LIGHT POLE
- HAND HOLE
- TRASH CAN
- SIGN POST
- TRAFFIC SIGNAL
- PEDESTRIAN SIGNAL
- DECIDUOUS TREE WITH TRUNK DIAMETER
- SPOT ELEVATION
- BITUMINOUS
- CONC
- CONC
- CONC
- WCR
- WCR
- LSA
- LSA
- SWL
- DWL
- R=
- I=
- TC=
- NPV
- BC=
- CATV
- D
- E
- G
- S
- T
- W
- BENCH MARK



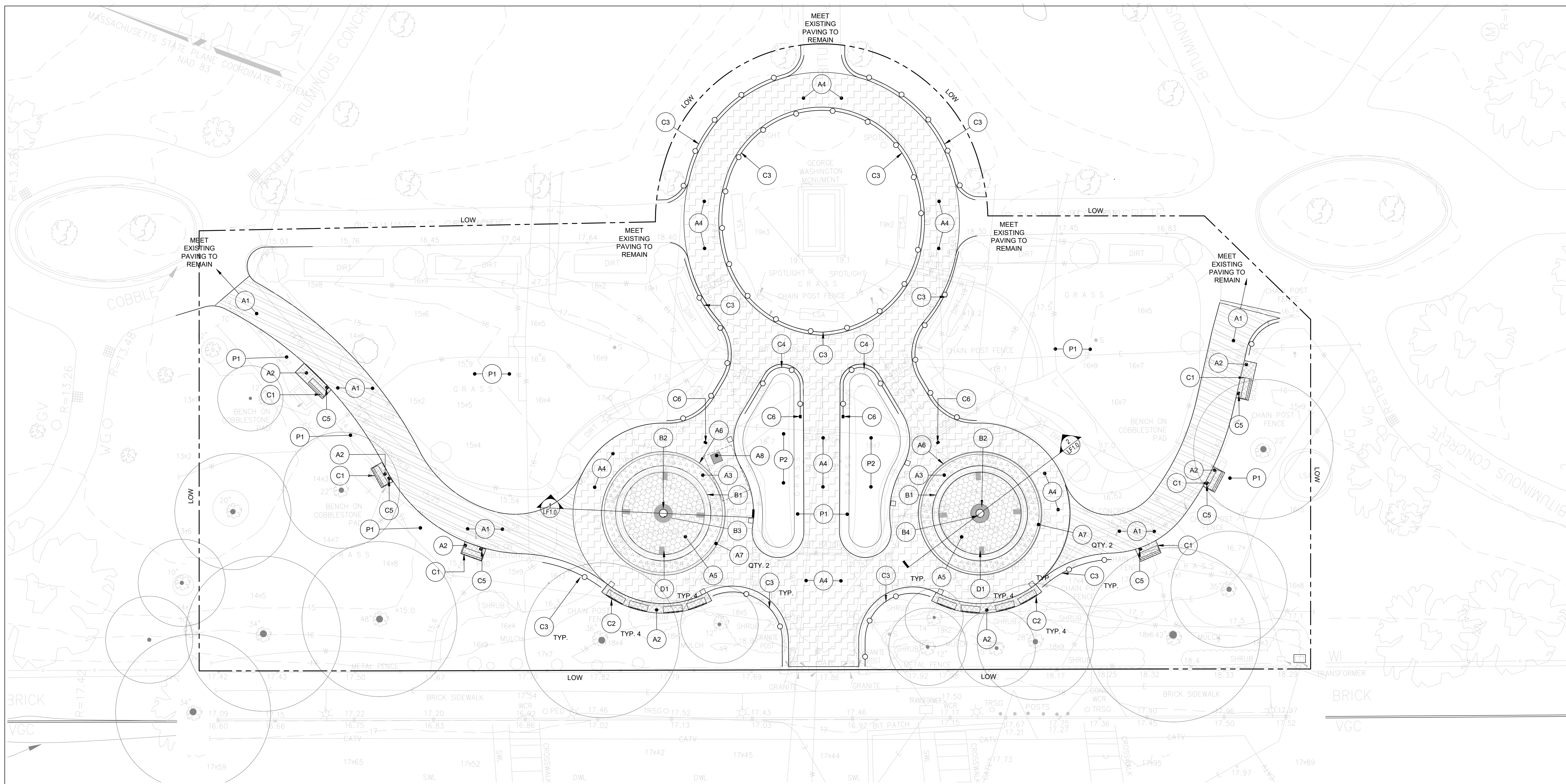

MATERIAL LEGEND

TAG	DESCRIPTION		
PAVING			
A1	BITUMINOUS CONCRETE PAVING, MATCH EXISTING		1 L5.0
A2	COBBLESTONE PAVING		2-3 L5.0
A3	EXPOSED AGGREGATE CONCRETE PAVING - COLOR TYPE 1		7 L5.0
A4	EXPOSED AGGREGATE CONCRETE PAVING - COLOR TYPE 2		7 L5.0
A5	PRECAST CONCRETE PAVERS FOUNTAIN FLOOR WITH EXPOSED AGGREGATE FINISH - COLOR TYPE 1		1 LF1.0 2 LF1.0
A6	GRANITE PAVER BAND		1-2 L5.1
A7	GRANITE PAVER WITH DEDICATION ENSCRIPTION		2 L5.1
A8	VAULT HATCH		4 L5.1

TAG	DESCRIPTION		
FOUNTAIN			
B1	EXISTING GRANITE PERIMETER FOUNTAIN COPING (REFURBISHED AND RESET)		1 LF1.0 2 LF1.0
B2	EXISTING GRANITE FOUNTAIN SCULPTURE BASE (REFURBISHED AND RESET)		1 LF1.0 2 LF1.0
B3	EXISTING BRONZE SCULPTURE OF SMALL CHILD (COORDINATED WITH CONSERVATOR AND RESET)		1 LF1.0 2 LF1.0
B4	EXISTING BRONZE SCULPTURE OF BOY AND BIRD (COORDINATED WITH CONSERVATOR AND RESET)		1 LF1.0 2 LF1.0
PLANTING			
P1	LAWN AREA - SEE PLANTING PLAN		5 L5.0
P2	SHRUB - REMOVE, PROTECT, AND REINSTALL - SEE PLANTING PLAN		6 L5.0

TAG	DESCRIPTION		
FURNISHINGS			
C1	EXISTING WOOD AND METAL BENCH (REFURBISHED AND RESET)		4 L5.0
C2	NEW BENCH - INSTALL ONLY (FURNISHED BY PROJECT OWNER)		4 L5.0
C3	EXISTING ORNAMENTAL POST AND CHAIN FENCE (REFURBISHED AND RESET)		
C4	EXISTING ORNAMENTAL PLANTER HOOP FENCE (REFURBISHED AND RESET)		
C5	BRONZE PLAQUE IN COBBLESTONE PAVING		2 L5.0
C6	BRONZE PLAQUE IN PLANT BED. INSTALL PLAQUE IN EXISTING LOCATIONS.		3 L5.1
C7	BRONZE PLAQUE IN EXPOSED AGGREGATE PAVING		7 L5.0
LIGHTING			
D1	SCULPTURE ACCENT LIGHTING AND METAL GRATING. SEE WATER FOUNTAIN DRAWINGS AND ELECTRICAL DRAWINGS		

MATERIALS NOTES:
 1. PROVIDE SUBMITTALS PRIOR TO PROCUREMENT OF MATERIALS
 2. SHOP DRAWINGS TO BE BASED ON FIELD MEASUREMENT AND LAYOUT VERIFICATION

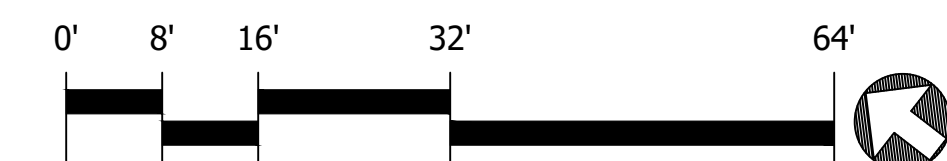

City of Boston
Parks and Recreation

FRIENDS OF THE
PUBLIC GARDEN
69 BEACON STREET
BOSTON, MA 02108
IN CONJUNCTION
WITH THE BOSTON
PARKS & RECREATION
DEPARTMENT

HALVORSON
Tight&Bond STUDIO

25 KINGSTON ST. BOSTON MA 02111-2900
PHONE: 617-534-8388
WWW.HALVORSONDESIGN.COM

RESTORATION OF CHILD FOUNTAINS
AND LANDSCAPE IMPROVEMENTS TO
THE ARLINGTON ST. ENTRANCE OF
THE PUBLIC GARDEN
BOSTON, MA

REVISIONS

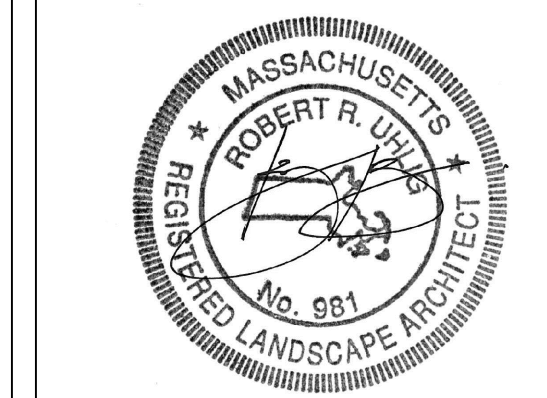

PROJECT NO: 155026001
 DRAWN BY: GH
 CHECKED BY: RH
 SCALE: 1/16" = 1'-0"

CONSTRUCTION
DOCUMENTS

MAY 2023

MATERIALS PLAN

L1.0



City of Boston
Parks and Recreation

FRIENDS OF THE
PUBLIC GARDEN
69 BEACON STREET
BOSTON, MA 02108

IN CONJUNCTION
WITH THE BOSTON
PARKS & RECREATION
DEPARTMENT

HALVORSON
TightBond STUDIO

55 KINDESTON ST. BOSTON MA 02111-2200
PH: 617.552.6280
WWW.HALVORSONDESIGN.COM

RESTORATION OF CHILD FOUNTAINS TO
AND LANDSCAPE IMPROVEMENTS TO
THE ARLINGTON ST. ENTRANCE OF
THE PUBLIC GARDEN
BOSTON, MA

REVISIONS

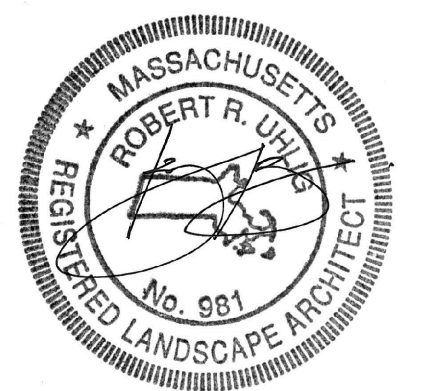

PROJECT NO: 155026001
DRAWN BY: SK
CHECKED BY: RH
SCALE: 1/16" = 1'-0"

CONSTRUCTION
DOCUMENTS

MAY 2023

LAYOUT PLAN

L2.0

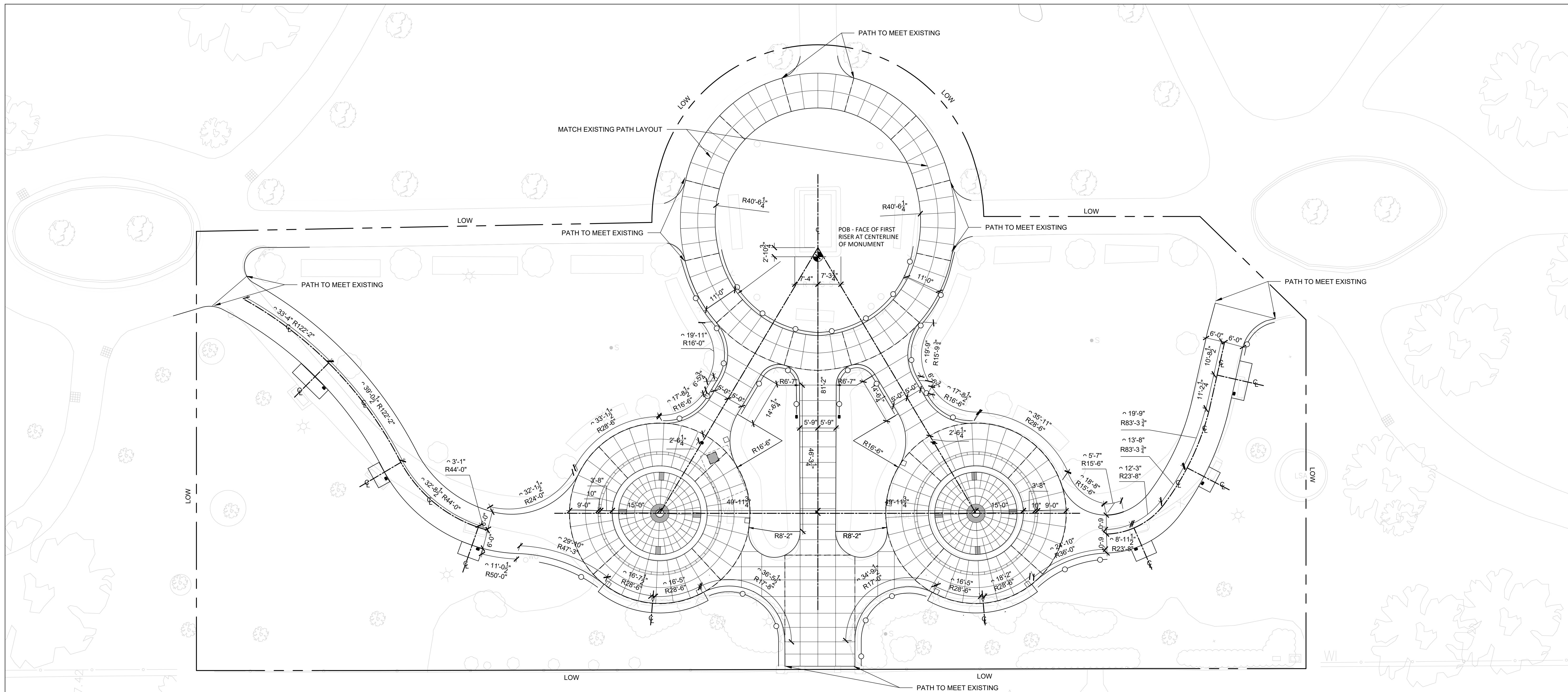

LAYOUT LEGEND

SYMBOL	DESCRIPTION
+	PLAN REFERENCE POINT
⊕	POINT OF BEGINNING
CP	CENTER POINT
CL	CENTER LINE
PT	POINT OF TANGENCY
PC	POINT OF CURVATURE
VIF.	VERIFY IN THE FIELD
JT	JOINT

LAYOUT NOTES:

- EXISTING CONDITIONS SURVEY (DATED: JULY 5TH, 2019) WAS PROVIDED BY NITSCH ENGINEERING, 2 CENTER PLAZA SUITE 240, BOSTON, MA 02108
- REVIEW DRAWINGS TO DETERMINE THE TOTAL SCOPE AND COORDINATION OF WORK. EMPLOY A LICENSED SURVEYOR OR REGISTERED CIVIL ENGINEER TO VERIFY AND LAYOUT GRADES, LINES AND DIMENSIONS SHOWN ON DRAWINGS. VERIFY EXISTING GRADES AND ELEVATIONS OF ADJACENT SITE CONDITIONS WITH ELEVATIONS ON DRAWINGS PRIOR TO BEGINNING WORK. IT IS THE RESPONSIBILITY OF THE CONTRACTOR TO REPORT DISCREPANCIES TO THE OWNER'S REPRESENTATIVE IMMEDIATELY AND RECEIVE WRITTEN INSTRUCTIONS PRIOR TO PROCEEDING WITH CONSTRUCTION.
- USE ONE SINGLE BENCHMARK FOR WORK.
- LINES ARE PARALLEL OR PERPENDICULAR TO LINES FROM WHICH THEY ARE MEASURED UNLESS OTHERWISE NOTED.
- DIMENSIONS ARE TO FACE OF CURB, WALL FACE, EDGE OR CENTER LINE OF IMPROVEMENT AS NOTED.
- DRAIN LAYOUT IS TO FACE OF ADJACENT CURB OR WALL AT CENTER POINT OF GRATE.
- MEET EXISTING CONDITIONS FOR GRADING AT PROJECT LIMIT LINE SMOOTHLY.
- SEE MATERIALS PLAN FOR DESCRIPTION OF ALL ELEMENTS SHOWN.
- STAKE PROPOSED CURBS, WALLS AND SITE ELEMENT LOCATIONS AND ELEVATIONS FOR OWNER'S REPRESENTATIVE'S APPROVAL PRIOR TO INSTALLATION OF FOUNDATIONS.

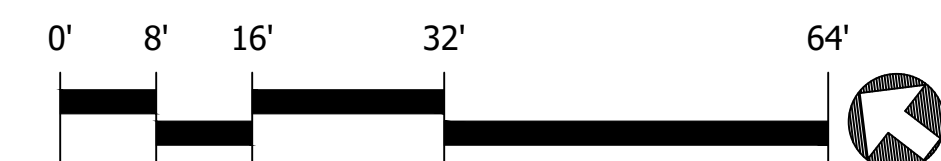



City of Boston
Parks and Recreation

FRIENDS OF THE
PUBLIC GARDEN
69 BEACON STREET
BOSTON, MA 02108

IN CONJUNCTION
WITH THE BOSTON
PARKS & RECREATION
DEPARTMENT

HALVORSON
Tight & Bond STUDIO

55 KINDESTON ST. BOSTON MA 02111-2200
PHONE: 617-552-0380
WWW.HALVORSONDESIGN.COM

RESTORATION OF CHILD FOUNTAINS TO
AND LANDSCAPE IMPROVEMENTS TO
THE ARLINGTON ST. ENTRANCE OF
THE PUBLIC GARDEN
BOSTON, MA

REVISIONS

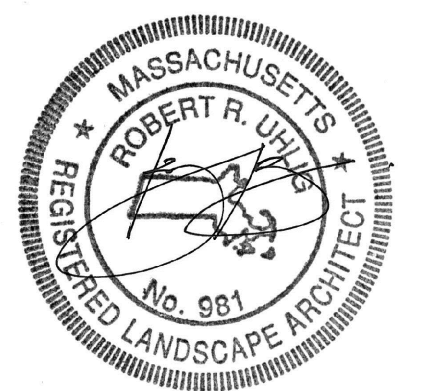

PROJECT NO: 155026001
DRAWN BY: SK
CHECKED BY: RH
SCALE: 1/16" = 1'-0"

CONSTRUCTION
DOCUMENTS

MAY 2023

JOINT LAYOUT PLAN

L2.1

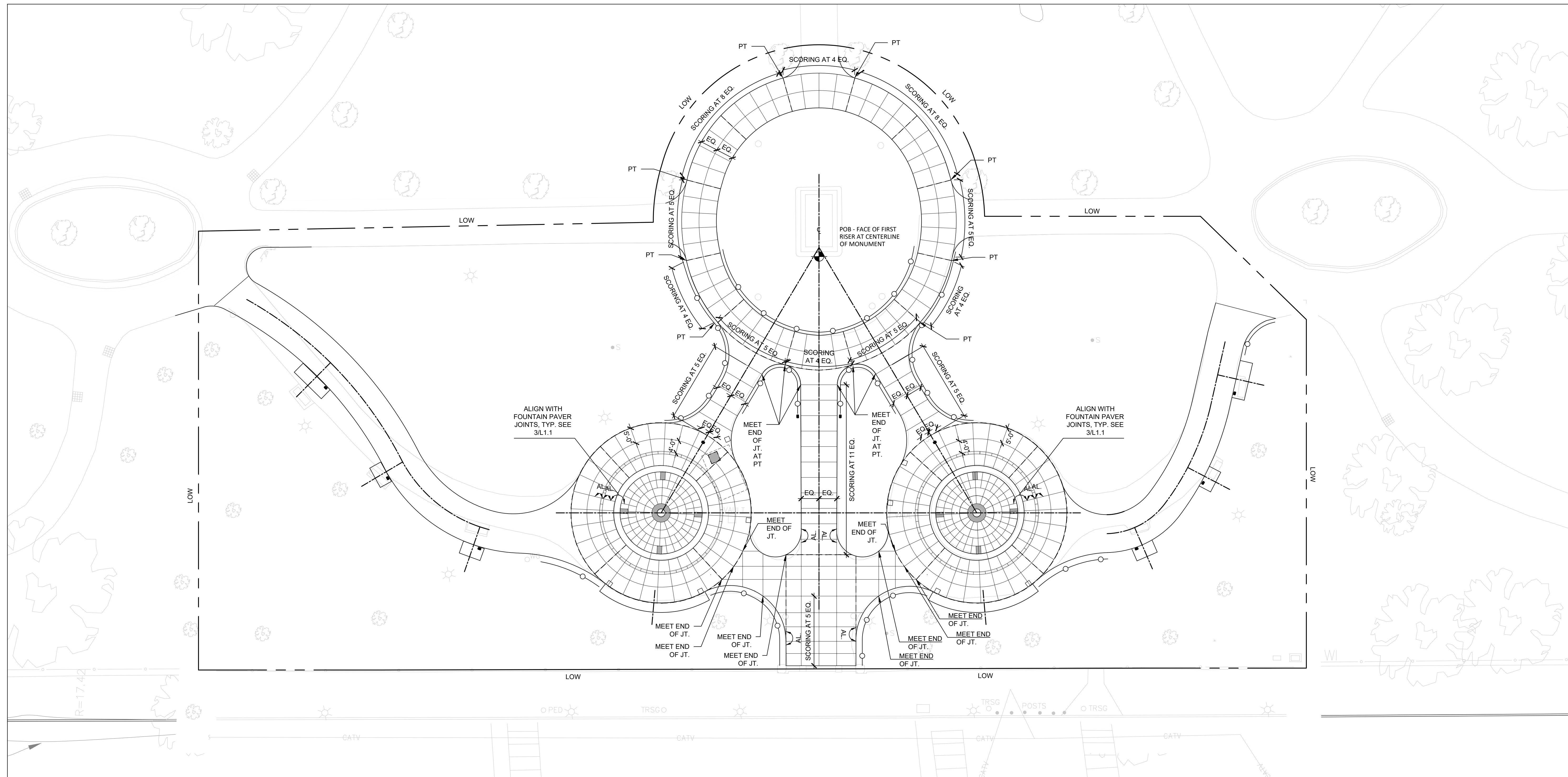

LAYOUT LEGEND

SYMBOL	DESCRIPTION
+	PLAN REFERENCE POINT
◆	POINT OF BEGINNING
CP	CENTER POINT
CL	CENTER LINE
PT	POINT OF TANGENCY
PC	POINT OF CURVATURE
VIF.	VERIFY IN THE FIELD
JT	JOINT
AL.	ALIGN
---	EXPANSION JOINT

LAYOUT NOTES:

- EXISTING CONDITIONS SURVEY (DATED: JULY 5TH, 2019) WAS PROVIDED BY NITSCH ENGINEERING, 2 CENTER PLAZA SUITE 240, BOSTON, MA 02108
- REVIEW DRAWINGS TO DETERMINE THE TOTAL SCOPE AND COORDINATION OF WORK. EMPLOY A LICENSED SURVEYOR OR REGISTERED CIVIL ENGINEER TO VERIFY AND LAYOUT GRADES, LINES AND DIMENSIONS SHOWN ON DRAWINGS. VERIFY EXISTING GRADES AND ELEVATIONS OF ADJACENT SITE CONDITIONS WITH ELEVATIONS ON DRAWINGS PRIOR TO BEGINNING WORK. IT IS THE RESPONSIBILITY OF THE CONTRACTOR TO REPORT DISCREPANCIES TO THE OWNER'S REPRESENTATIVE IMMEDIATELY AND RECEIVE WRITTEN INSTRUCTIONS PRIOR TO PROCEEDING WITH CONSTRUCTION.
- USE ONE SINGLE BENCHMARK FOR WORK.
- LINE ARE PARALLEL OR PERPENDICULAR TO LINES FROM WHICH THEY ARE MEASURED UNLESS OTHERWISE NOTED.
- DIMENSIONS ARE TO FACE OF CURB, WALL FACE, EDGE OR CENTER LINE OF IMPROVEMENT AS NOTED.
- DRAIN LAYOUT IS TO FACE OF ADJACENT CURB OR WALL AT CENTER POINT OF GRATE.
- MEET EXISTING CONDITIONS FOR GRADING AT PROJECT LIMIT LINE SMOOTHLY.
- SEE MATERIALS PLAN FOR DESCRIPTION OF ALL ELEMENTS SHOWN.
- STAKE PROPOSED CURBS, WALLS AND SITE ELEMENT LOCATIONS AND ELEVATIONS FOR OWNER'S REPRESENTATIVE'S APPROVAL PRIOR TO INSTALLATION OF FOUNDATIONS.

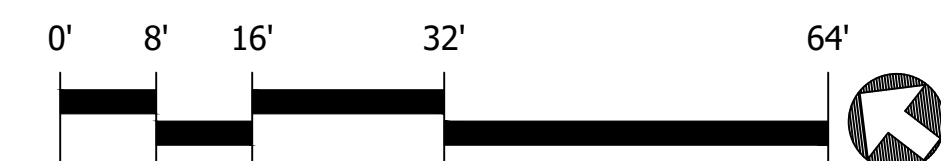



City of Boston
Parks and Recreation

FRIENDS OF THE
PUBLIC GARDEN
69 BEACON STREET
BOSTON, MA 02108

IN CONJUNCTION
WITH THE BOSTON
PARKS & RECREATION
DEPARTMENT

HALVORSON
Tight & Bond STUDIO

55 KINDESTON ST. BOSTON MA 02111-2200
617.552.6000
WWW.HALVORSONDESIGN.COM

RESTORATION OF CHILD FOUNTAINS
AND LANDSCAPE IMPROVEMENTS TO
THE ARLINGTON ST. ENTRANCE OF
THE PUBLIC GARDEN
BOSTON, MA

REVISIONS

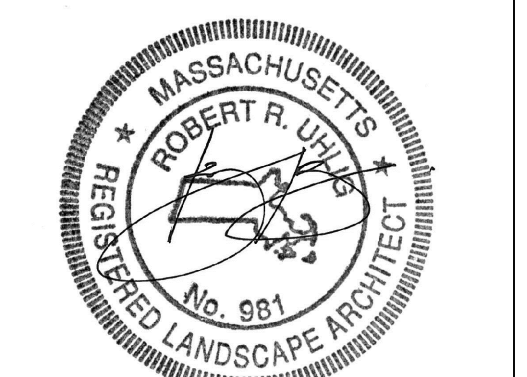

PROJECT NO: 155026001
DRAWN BY: GH
CHECKED BY: RH
SCALE: AS NOTED

CONSTRUCTION
DOCUMENTS

MAY 2023
LANDSCAPE
FOUNTAIN DETAILS

LF1.0

NOTES:
1. SEE WATER FEATURE DRAWINGS FOR FOUNTAIN MECHANICAL AND ELECTRICAL INFORMATION
2. NON-FROST SUSCEPTIBLE MATERIAL EXCEPT WHERE THE DISTANCE BETWEEN THE SPRINGLINE OF THE PIPES IS LESS THAN 1.5 TIMES THE PIPE DIAMETER. USE EXCAVATABLE FLOWABLE CONTROLLED DENSITY FILL
3. ALL METAL WITHIN 5'-0" OF WATER FEATURER LARGER THAN 4" X 4" TO BE BONDED AS PER NEC 680 - SEE WATER FOUNTAIN DRAWINGS
STRUCTURAL NOTES:
THE FOUNTAIN BASE STRUCTURAL SLAB SHALL BE A MINIMUM OF 10" THICK AT ALL LOCATIONS THROUGHOUT THE FOUNTAIN EXTENTS, AND SHALL BE COMPRISED OF 5,000PSI AIR ENTRAINED NORMALWEIGHT CONCRETE. THE SLAB IS TO BE REINFORCED WITH #5 BARS @ 12" O.C. MAXIMUM SPACING TOP AND BOTTOM EACH WAY WITH HOOKS AND BENDS AS SHOWN IN SECTION. THE REINFORCEMENT SHALL BE DEFORMED BAR CONFORMING TO ASTM A615 - GR 60. THE CONTINUOUS BARS SHALL BE LAPPED 2'-6" TO ACCOMMODATE CONSTRUCTION INSTALLATION, WHILE KEEPING THE CONFIGURATION AS SHOWN. (4) ADDITIONAL #5 BARS (12" LONG) SHALL BE PLACED ON EACH SLAB FACE OF VERTICAL SLAB PENETRATIONS TO REINFORCE THE OPENINGS (SEE BELOW).

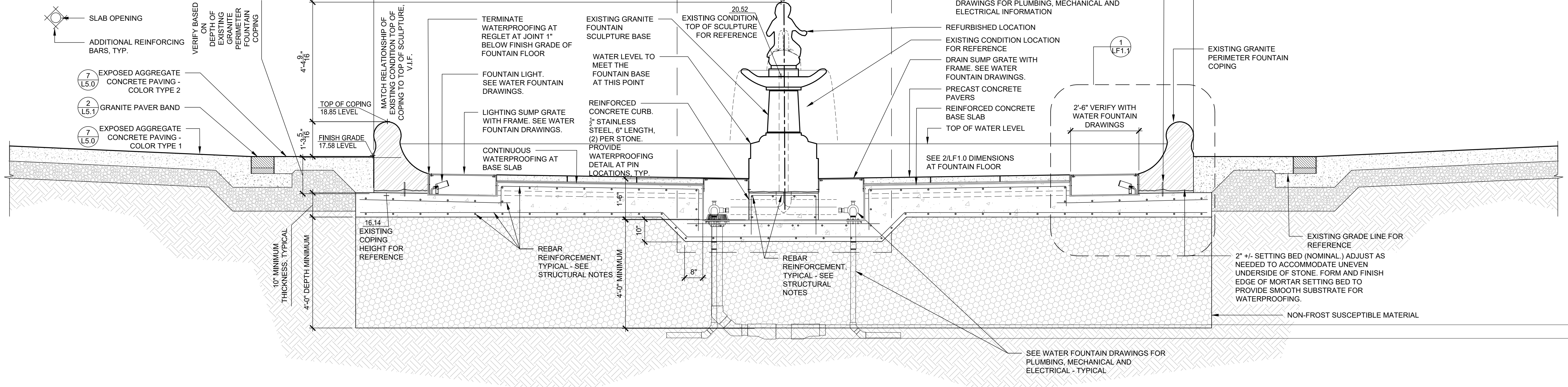

1 NORTH FOUNTAIN AND 'SMALL CHILD' SCULPTURE
SCALE: 1/2" = 1'-0"

NOTES:
1. SEE WATER FOUNTAIN DRAWINGS FOR FOUNTAIN MECHANICAL AND ELECTRICAL INFORMATION
2. SEE 1/LF1.0 FOR MATERIAL INFORMATION
3. SEE 1/LF1.0 FOR GENERAL NOTES AND STRUCTURAL NOTES

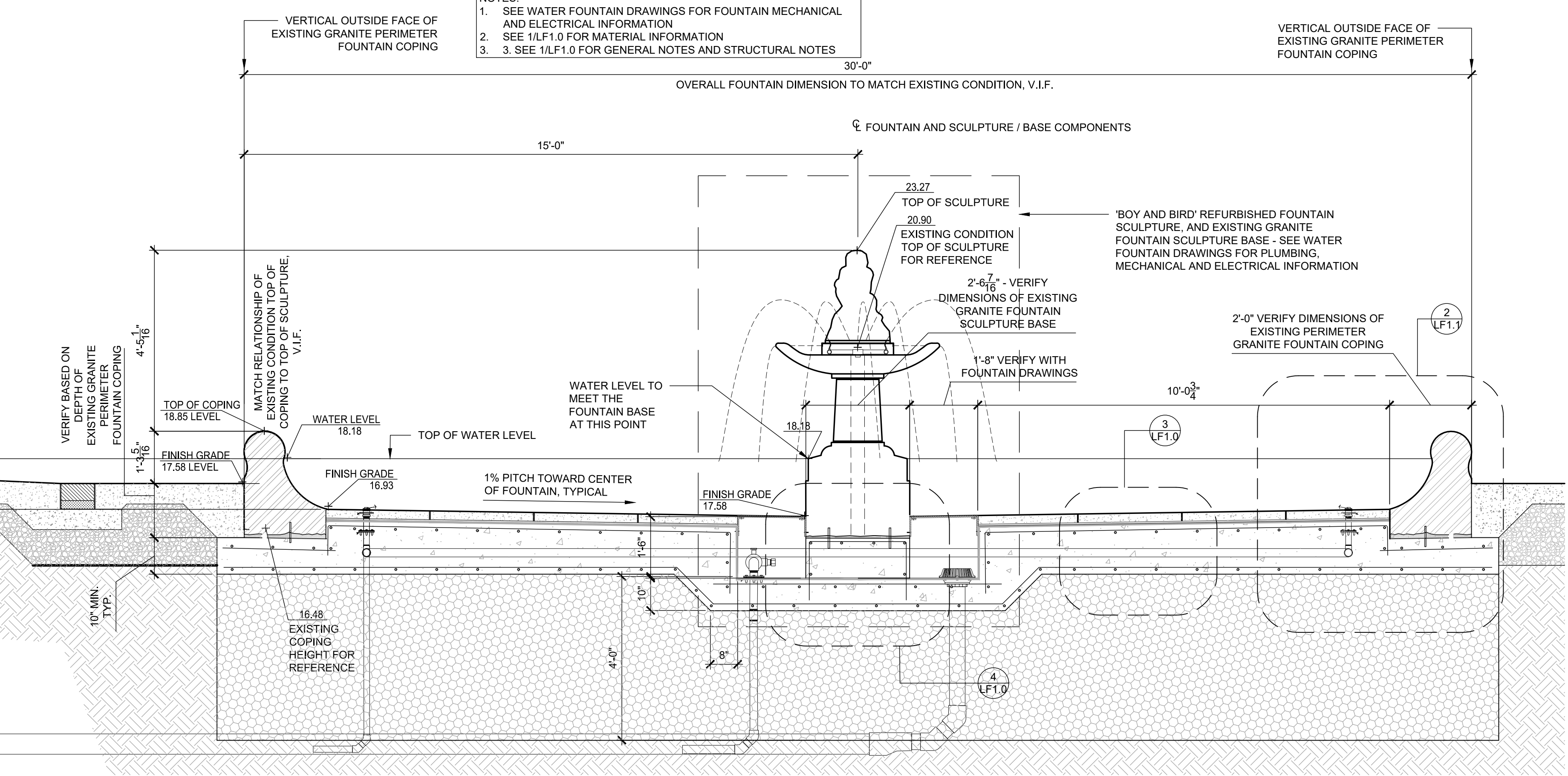

2 SOUTH FOUNTAIN AND 'BOY AND BIRD' SCULPTURE
SCALE: 1/2" = 1'-0"

SEE FOUNTAIN ENLARGEMENT PLAN FOR EXPANSION JOINT LOCATIONS - EXPANSION JOINTS TO BE 1/2" AND INCLUDE JOINT SEALANT, BACKER ROD AND FULL DEPTH JOINT FILLER, SEALANT RECESSED 1/2" FROM TOP SURFACE OF CONCRETE BASE

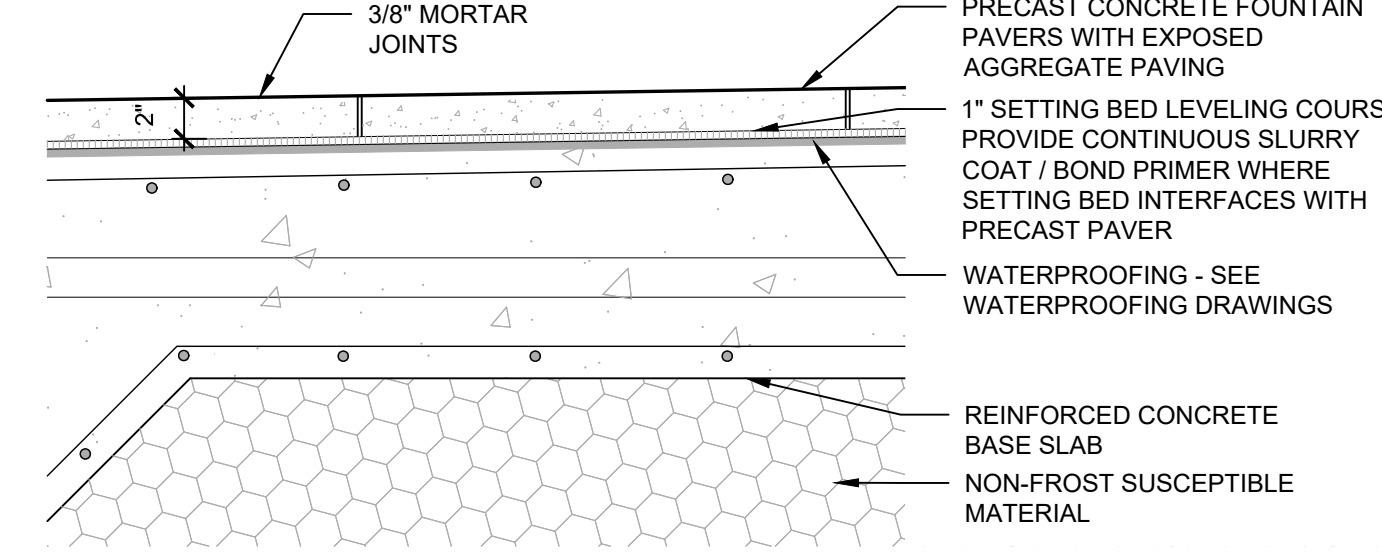

3 FOUNTAIN FLOOR
SCALE: 1" = 1'-0"

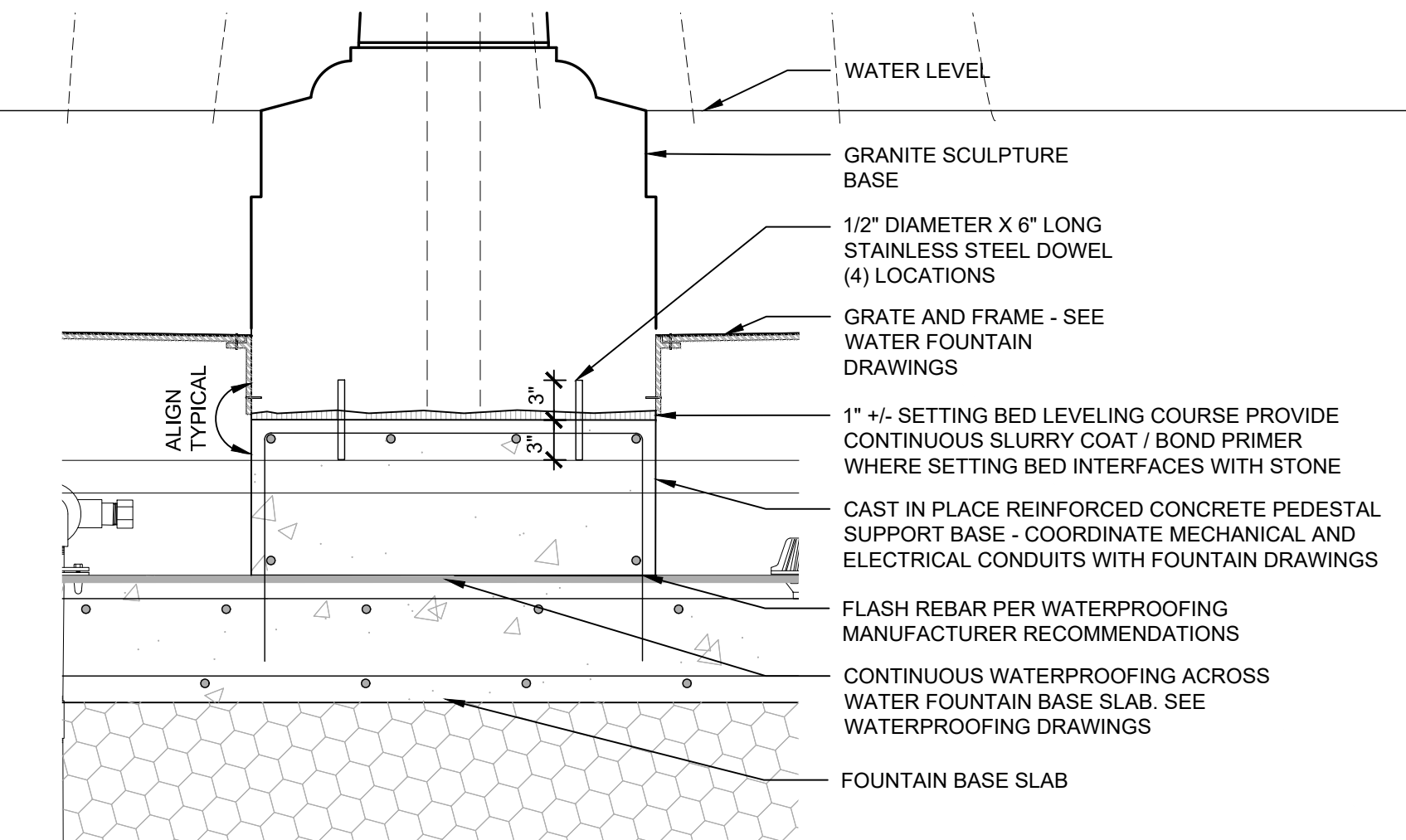

4 CONCRETE CURB UNDER FOUNTAIN BASE
SCALE: 1" = 1'-0"



City of Boston
Parks and Recreation

FRIENDS OF THE
PUBLIC GARDEN
69 BEACON STREET
BOSTON, MA 02108
IN CONJUNCTION
WITH THE BOSTON
PARKS & RECREATION
DEPARTMENT

HALVORSON
TightBond STUDIO

25 KINGTON ST. BOSTON MA 02111-2000
PH: 617.552.6200
WWW.HALVORSONDESIGN.COM

RESTORATION OF CHILD FOUNTAINS
AND LANDSCAPE IMPROVEMENTS TO
THE ARLINGTON ST. ENTRANCE OF
THE PUBLIC GARDEN
BOSTON, MA

REVISIONS

PROJECT NO: 155026001
DRAWN BY: DE
CHECKED BY: DE
SCALE: 1/2"=1'-0"

CONSTRUCTION
DOCUMENTS

MAY 2023

FOUNTAINS
SECTIONS

W3.0

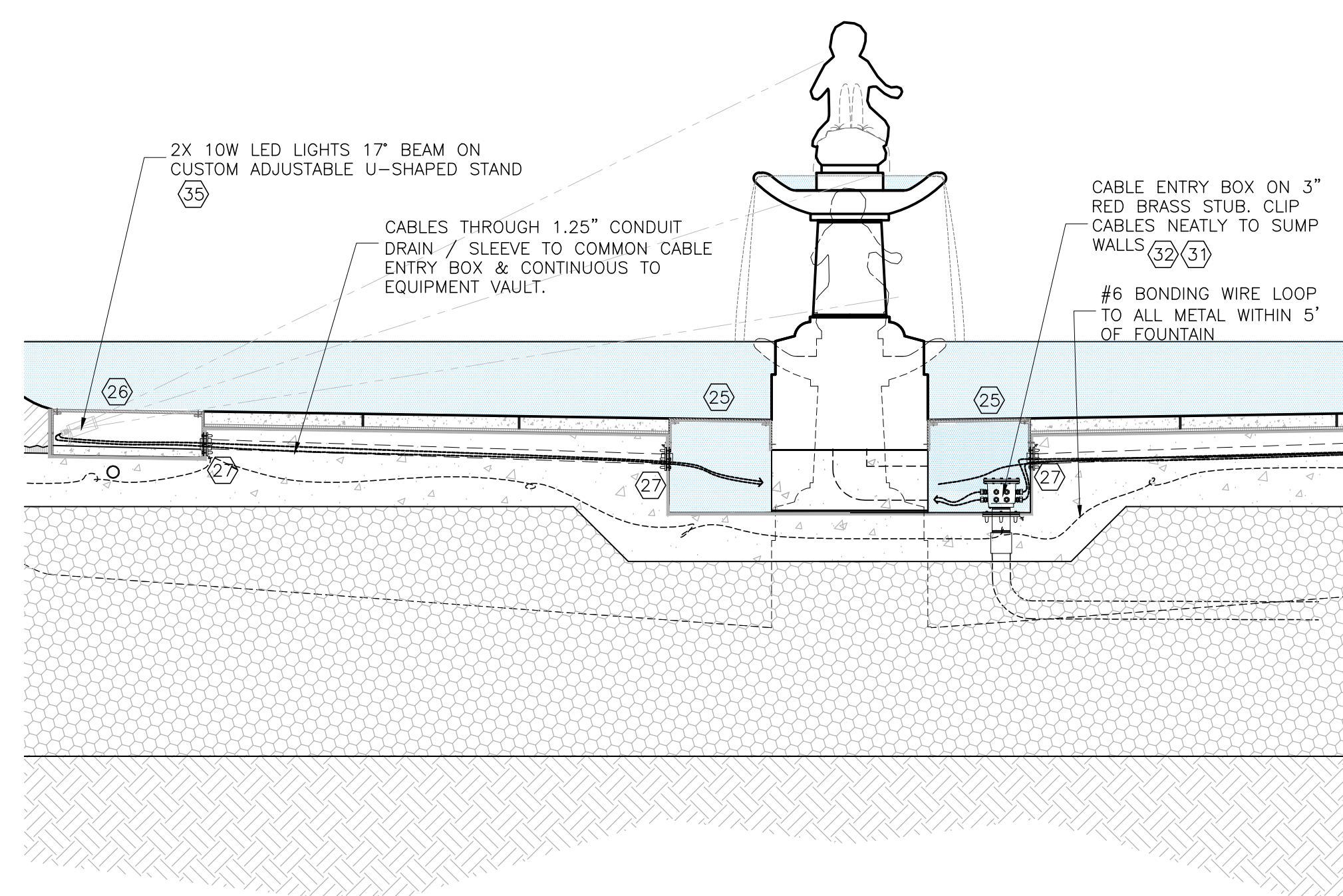

1 SMALL CHILD FOUNTAIN - ELECTRICAL SECTION
Scale: 1/2" = 1'-0"

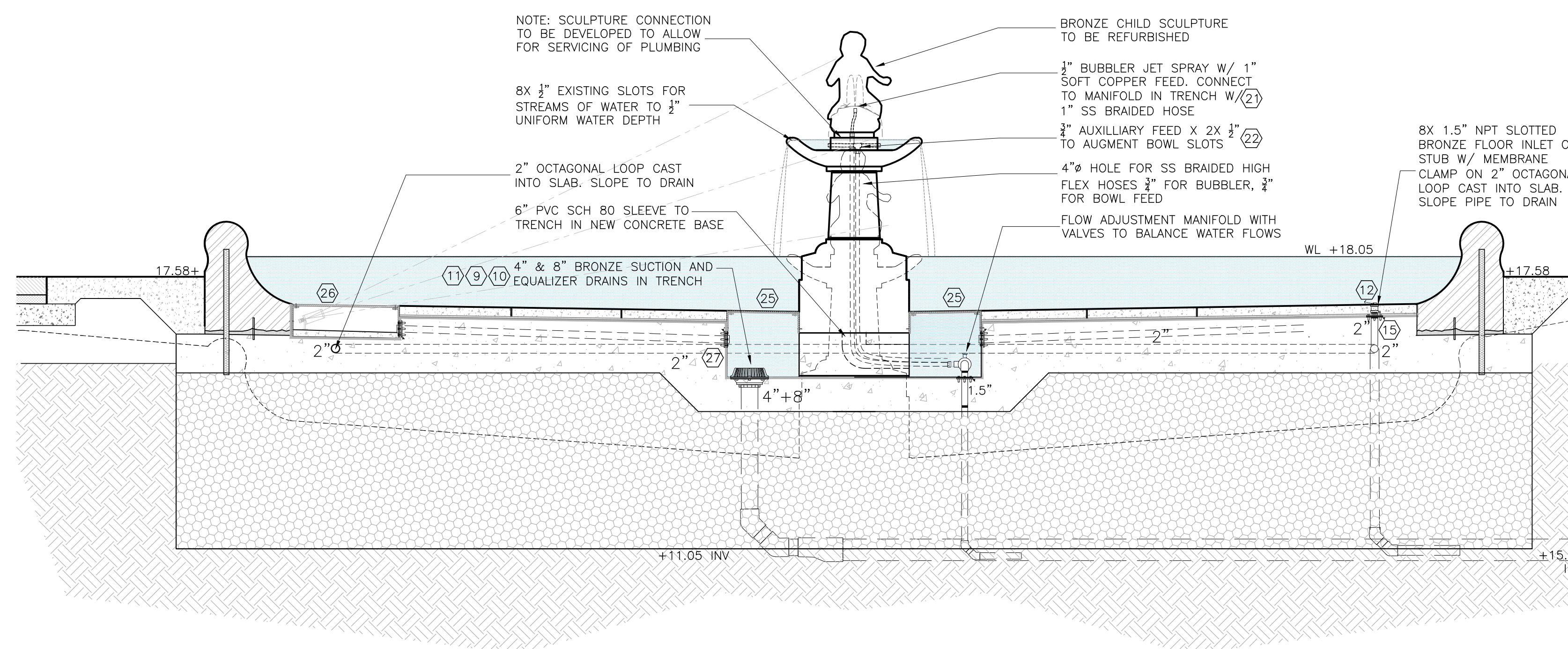

2 SMALL CHILD FOUNTAIN - MECHANICAL SECTION
Scale: 1/2" = 1'-0"

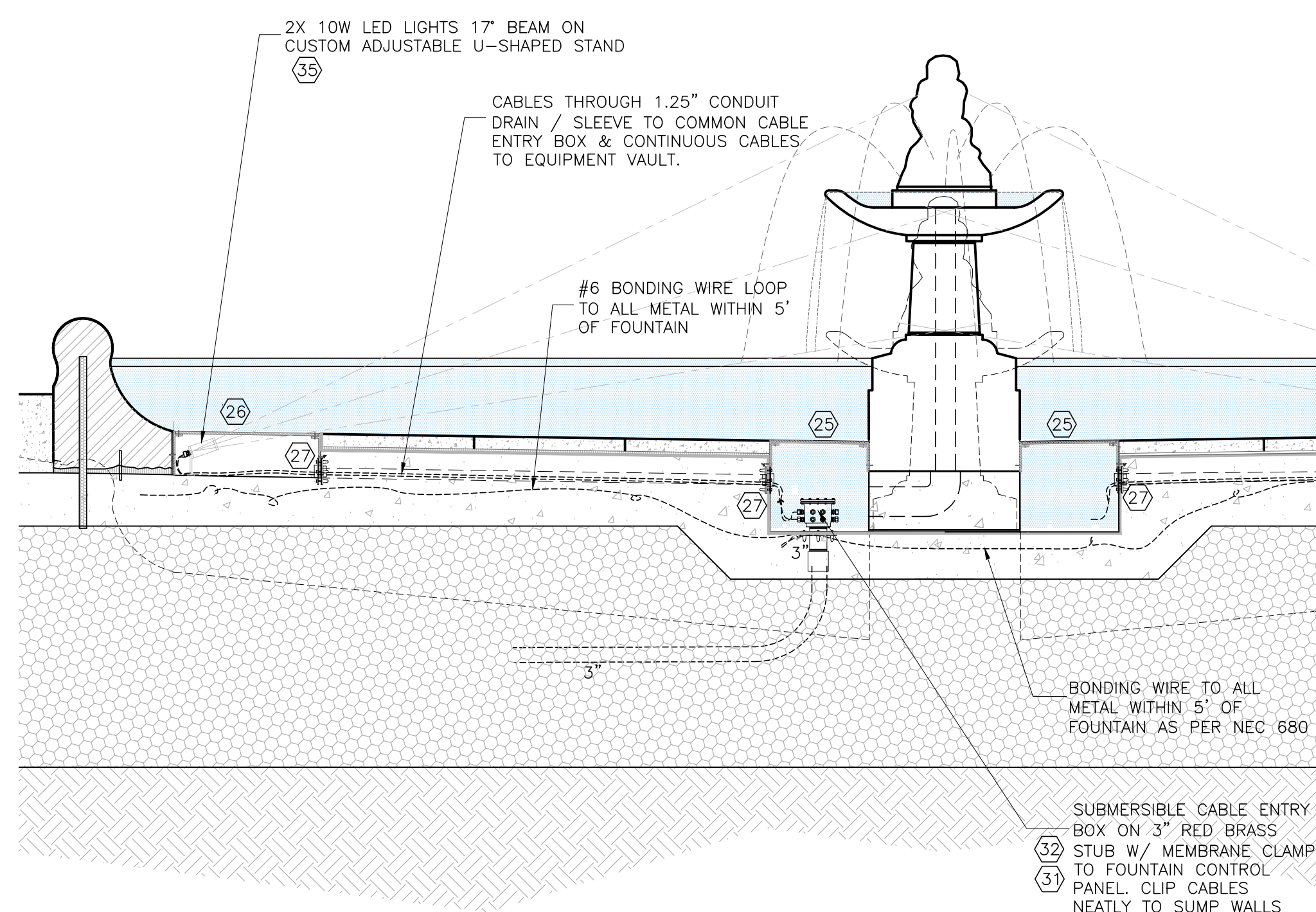

3 BOY AND BIRD FOUNTAIN - ELECTRICAL SECTION
Scale: 1/2" = 1'-0"

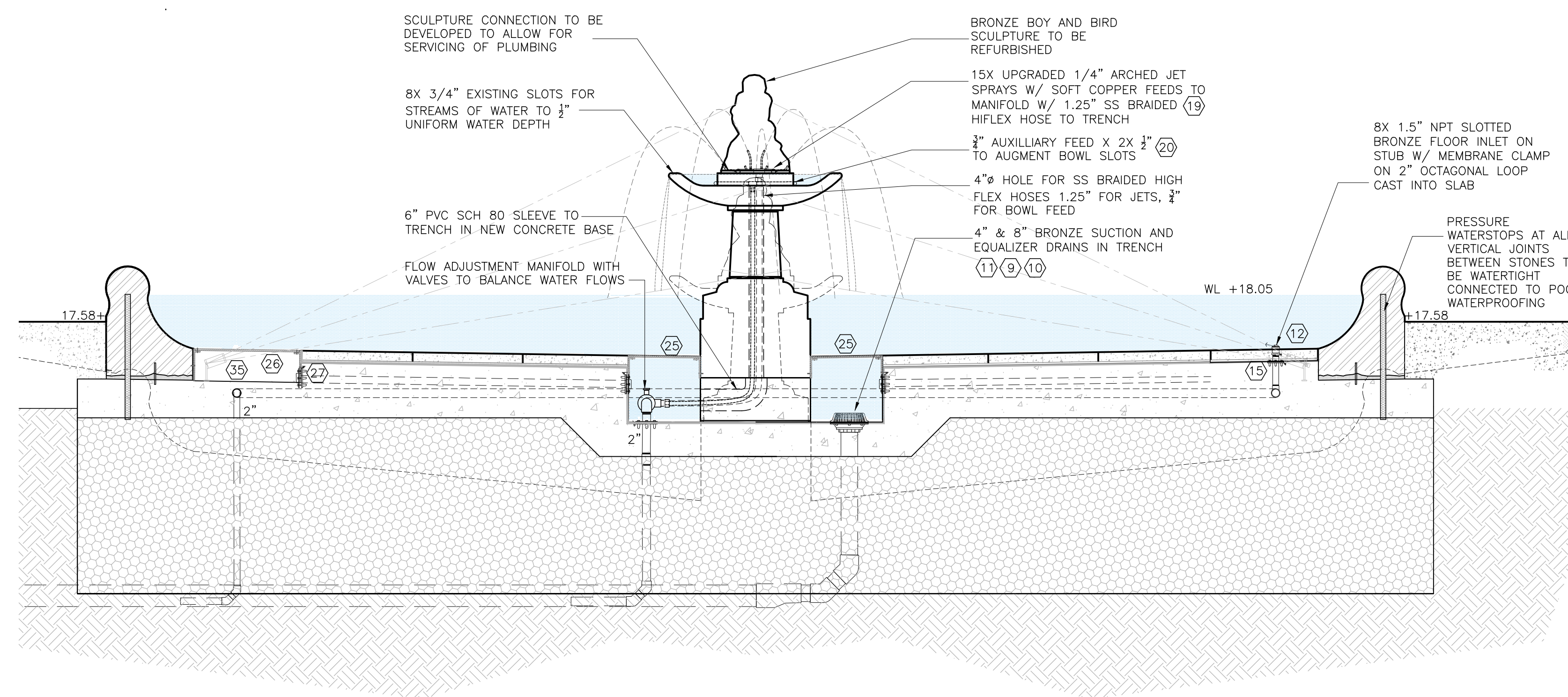

4 BOY AND BIRD FOUNTAIN - MECHANICAL SECTION
Scale: 1/2" = 1'-0"

FOR WATER FEATURE HEX SYMBOLS SEE SPECIFICATIONS
1-29 131212-2.2 WATER FEATURE MECHANICAL
30-35 131215-2.2 WATER FEATURE ELECTRICAL

STATE PLANE COORDINATE SYSTEM
NAD 83

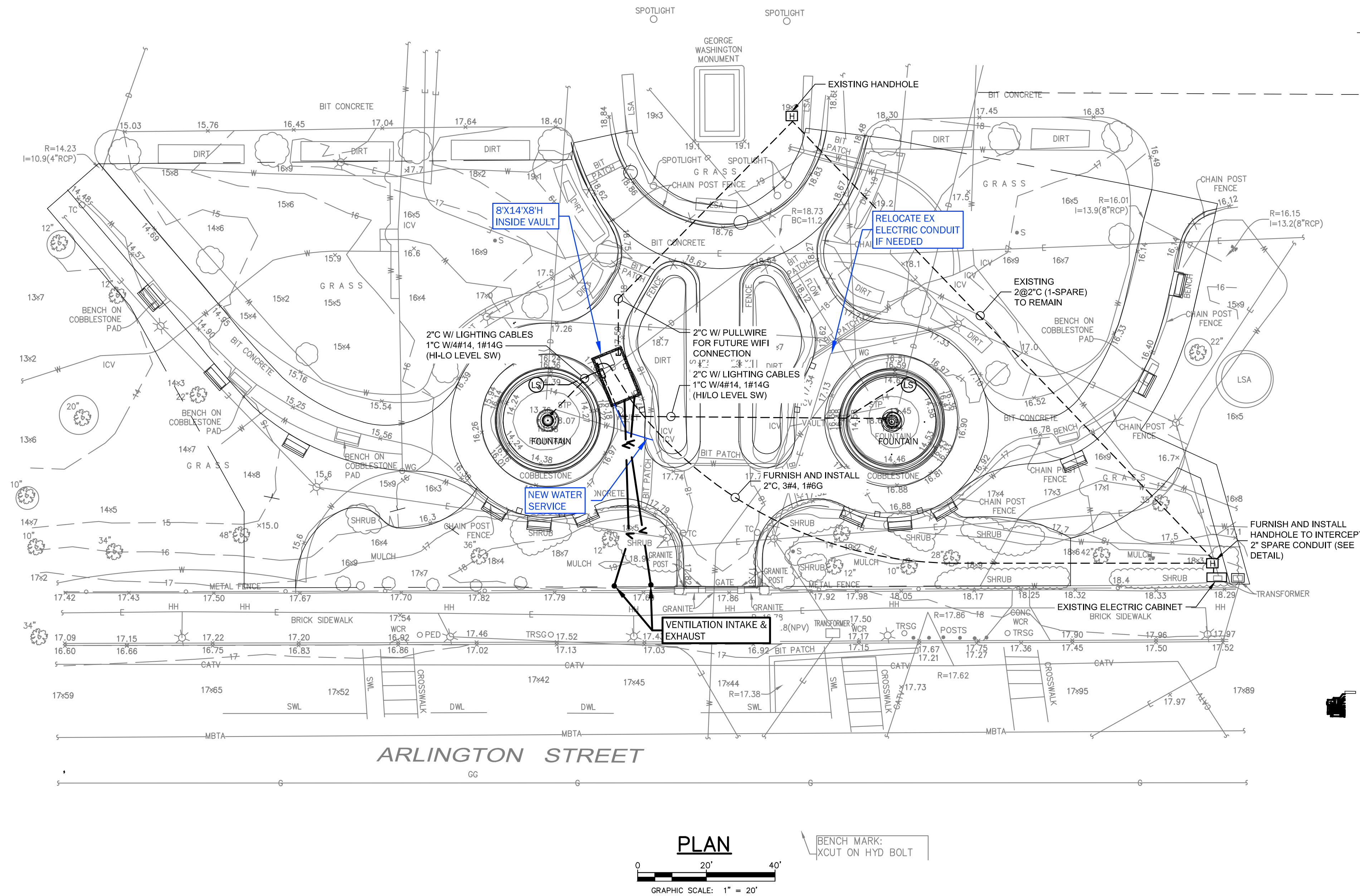

ELECTRICAL LEGEND

- UNDERGROUND CONDUIT
- HANDHOLE (BOSTON STREET LIGHTING STANDARD)
- HI-LO LEVEL SWITCH
- FOUNTAIN LIGHTING CONTROL CABINET
- FAN
- PUMP

PANEL 'P2'

100A, 120/240V, 1Ø, 3W 10KAC, 80A MCB - NEMA 3R ENCLOSURE

CKT NO	BKR SIZE	LOAD DESCRIPTION	LOAD DESCRIPTION	BKR SIZE	CKT NO
1	30	WATER FEATURE CP	VAULT RECEPTACLES	20	2
3	20	SUMP PUMP CONTROL PUMP	HVAC CONTROLS	20	4
5			7.5 KW ELECTRIC HEATER	40	6
7	15	VAULT LIGHTING			8
9	20	LEAK DETECTOR / CELLULAR DIALER	FILTRATION PUMP	40	10
11	20	DEHUMIDIFIER RECP			12
13	15	SPARE	SCULPTURE DISPLAY PUMP	15	14
15	20	EXHAUST FAN	SPARE	20	16
17	20	OVERFLOW VALVE	AUTOFILL VALE	20	18
19	15	SPARE	SPARE	20	20
21	20	SPARE	SPARE	20	22
23	20	SPARE	SPARE	20	24

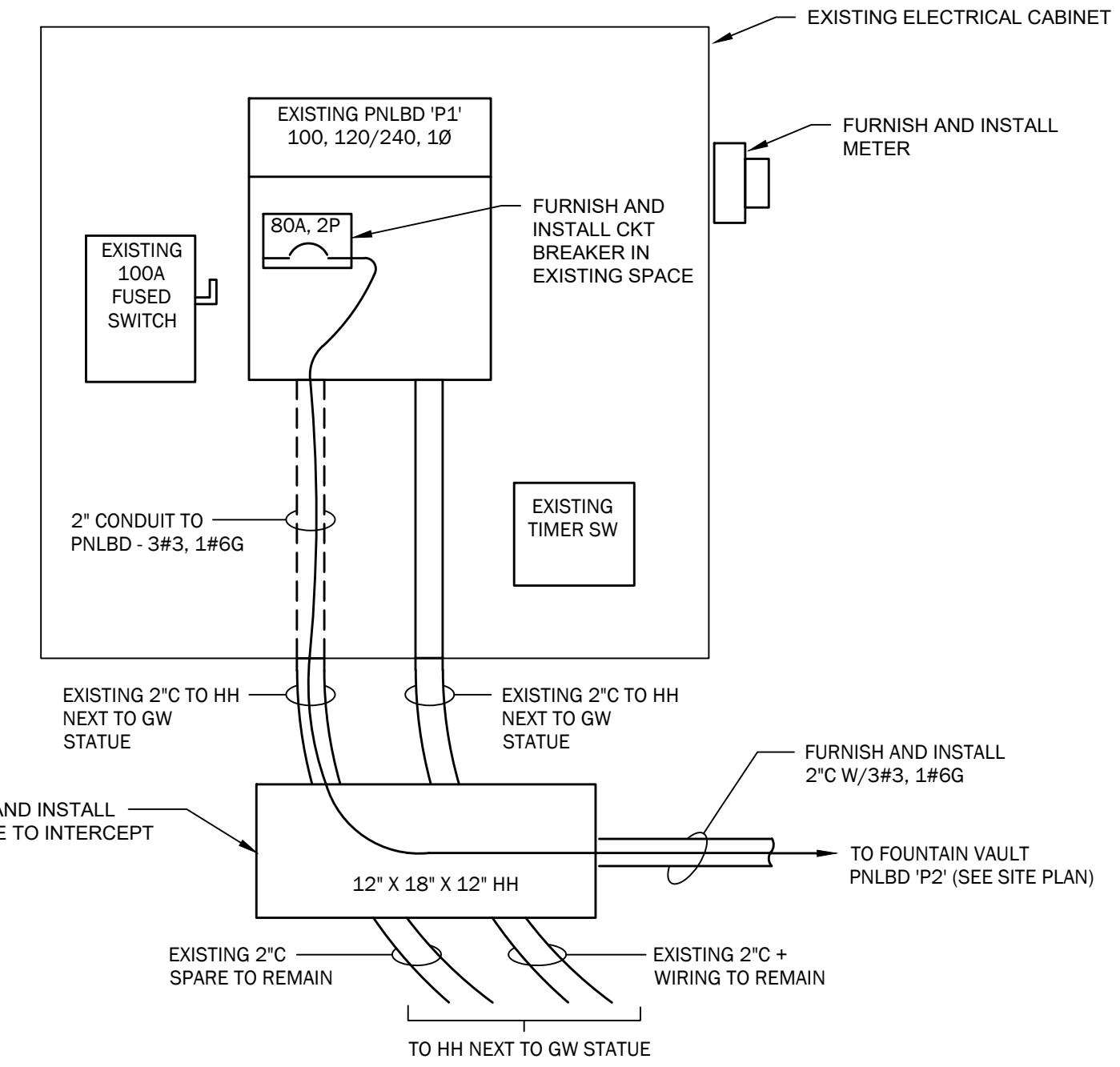

EXISTING ELECTRICAL CABINET DETAIL
NOT TO SCALE

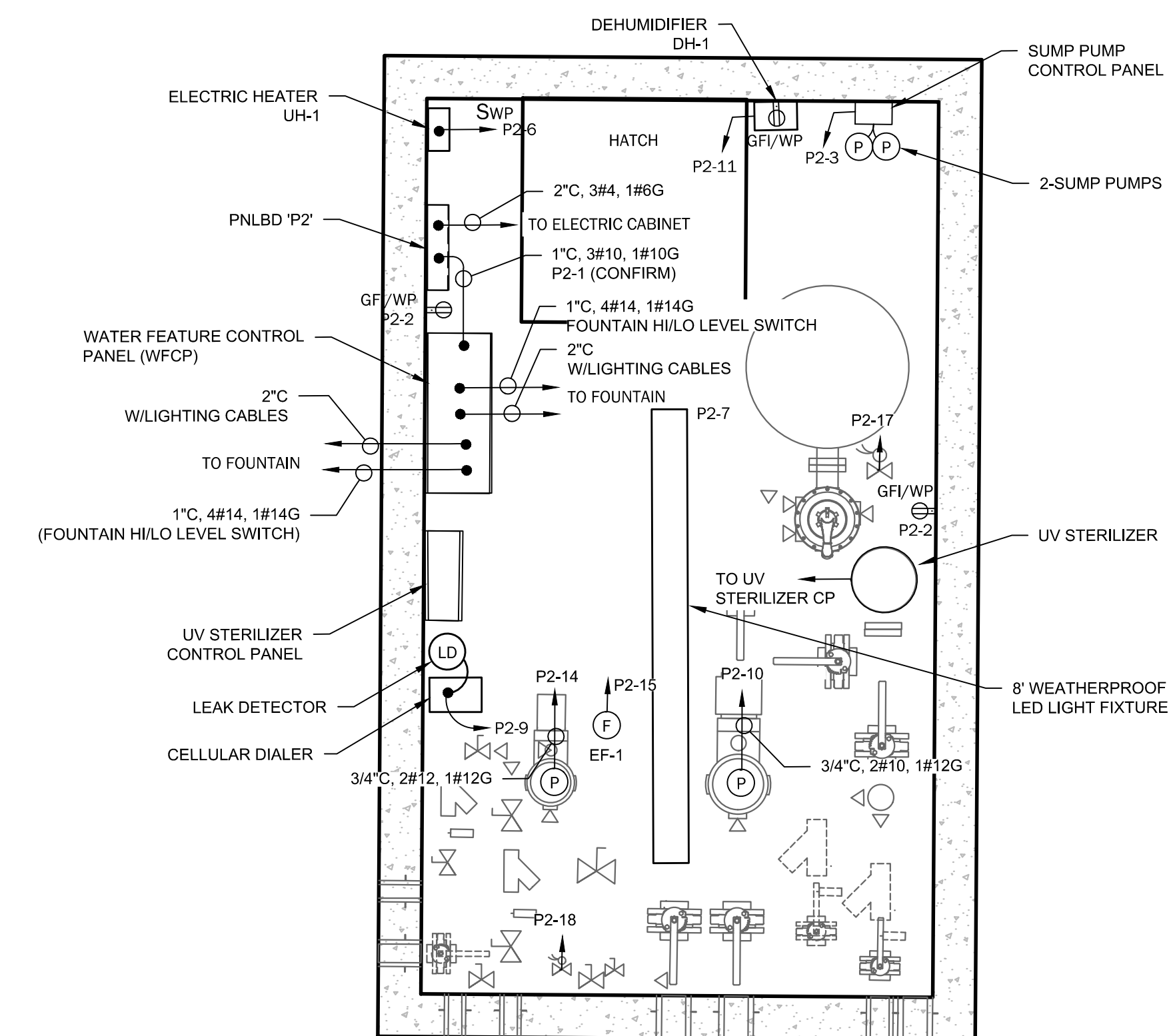

FOUNTAINS VAULT DETAIL
NOT TO SCALE



City of Boston
Parks and Recreation

FRIENDS OF THE
PUBLIC GARDEN
69 BEACON STREET
BOSTON, MA 02108

IN CONJUNCTION
WITH THE BOSTON
PARKS & RECREATION
DEPARTMENT

HALVORSON
Tight & Bond STUDIO

55 KINDESTON ST, BOSTON MA 02111-2200
PH: 617-552-6380
WWW.HALVORSONDESIGN.COM

RESTORATION OF CHILD FOUNTAINS TO
AND LANDSCAPE IMPROVEMENTS TO
THE ARLINGTON ST. ENTRANCE OF
THE PUBLIC GARDEN
BOSTON, MA

REVISIONS

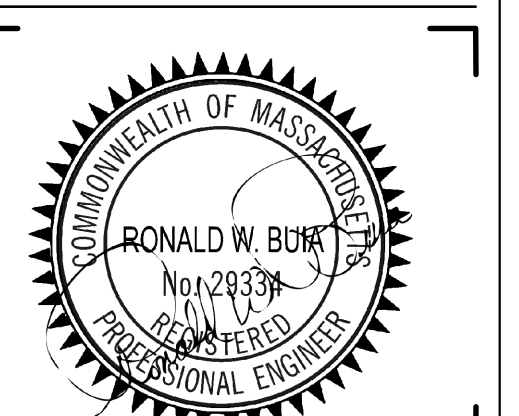

PROJECT NO: 155026001
DRAWN BY: KML
CHECKED BY: RWB
SCALE: 1" = 20'

CONSTRUCTION
DOCUMENTS

MAY 2023

POWER PLAN

E1.0